

Pharmaceuticals • Nutraceuticals  
Cosmetics • Consumer Goods  
Diagnostics • Medical Devices



## Applications

- Assembly
- Pick & Place
- Inspection
- Machine Load/Unload
- Collation
- Flexible Feeding Systems
- Carton & Case Loading
- Syringe Filling & Capping

## Also See:

- *TaskMate*<sup>®</sup> Blister Loading System for Blister Packaging Machines and Thermoformers
- *TaskMate*<sup>®</sup> Flex Feeders for Parts Feeding
- *TaskMate*<sup>®</sup> Aseptic Syringe Filling & Capping System



ESS Technologies, Inc.  
3160 State Street  
Blacksburg, VA 24060  
(540) 961-5716 • (540) 961-5721  
info@esstechnologies.com  
www.esstechnologies.com

# *TaskMate*<sup>®</sup> *Robotic Systems*



**Machine Loading/Unloading • Pick & Place • Carton/Case Loading  
Product Collation • Product Orientation • Inspection & Sampling**

*TaskMate*<sup>®</sup> Robotic Systems offers a solution for automating a wide range of processes for producing and packaging consumer goods, pharmaceuticals, cosmetics, diagnostics, and medical devices. The basic *TaskMate*<sup>®</sup> system includes a FANUC robot (model varies by application), robot base, robot tooling, PLe-rated interlocked safety guarding, controls and programming. The custom-designed end-of-arm tooling (EOAT) handles virtually any product.

ESS Technologies, Inc. is an authorized system integrator for FANUC Robotics and a strategic partner for the secondary packaging of pharmaceuticals..

## FANUC Robot Models

- Model LR200iD . . . . . 7kg Payload
- Model M-1iA . . . . . 0.5kg Payload
- Model M-2iA . . . . . 6kg Payload
- Model M-3iA . . . . . 6kg Payload
- Model M-10iA . . . . . 10kg Payload
- Model SR-3iA . . . . . 3kg Payload
- Model SR-6iA . . . . . 6kg Payload



## Typical Applications



Loading an SC60 Cartoner

- Machine Load/Unload
  - Cartoners
  - Blister Packaging Machines
  - Thermoformers
  - Medical Device Assembly Systems



Pick & Place Plugs in Bottles

- Pick & Place Applications
  - Kit Packaging
  - Robot Handles a Wide Range of Products
  - Vision and Line Tracking Enables Robot Precision



Loading Cartons

- Carton/Case Loading
  - Easily Integrates with Carton Erecting / Closing Equipment
  - Increase Productivity



Flex Feeder for Syringes

- Product Collation/Dispensing
- Product Orientation
  - Reduce Repetitive Tasks
  - Increase Productivity
- Flex Feeders for Machine Feeding



Sampling Laboratory Bottle Weights

- Product Inspection
- Product Sampling
  - High Speed Accuracy
  - Reduce Repetitive Tasks

## Technical Specifications

Item	Specification
Standard Voltage	120VAC, Single Phase, 60Hz
EOAT	Vacuum, Gripper, Hybrid
Guarding	PL-rated, Interlocked Polycarbonate
Size Changeover	10-15 Minutes Typical
Robotic Cell Footprint	Varies by Application

## Options

- Vision Inspection System
- Line Tracking
- Plug and Play Features
- Quick Change Tooling
- Clean Class Robot Option
- 120VAC Power Supply
- Casters
- Light Curtains
- Dual Safety Check (DCS) Software

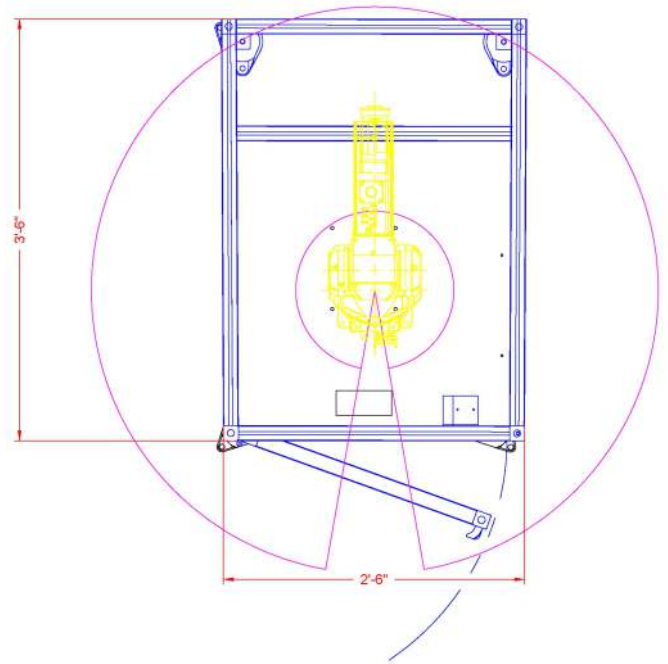

Typical Robotic Cell Layout  
(Actual Layout Varies By Robot Model and Application)

ESS Technologies, Inc.  
3160 State Street  
Blacksburg, VA 24060  
(540) 961-5716 • (540) 961-5721  
info@esstechnologies.com  
www.esstechnologies.com



**ESS**  
*Technologies, Inc.*   
Packaging Machine Design & Integration

