

Pharmaceuticals • Nutraceuticals
Cosmetics • Consumer Goods
Diagnostics • Medical Devices



Features

- Very compact footprint
- Cost-effective mechanical drive, filling and capping systems (servo option available)
- Manual bottle & cap feeding further reduces system cost and space requirements
- No Bottle - No Cap - No Fill Standard
- UL certified panel and controls
- Polycarbonate interlocked safety guarding
- Zero backlash indexer
- Fast size changeover



ESS Technologies, Inc.
3160 State Street
Blacksburg, VA 24060
(540) 961-5716 • (540) 961-5721
info@esstechnologies.com
www.esstechnologies.com

MB25 Mini Monoblock Filler/Capper



The Model MB25 Mini Monoblock Filler/Capper provides an affordable, ultra compact machine. Ideal for pharmaceutical, cosmetic, and diagnostic applications, the mechanical drive, filling, and capping systems handle up to 60 small bottles, tubes or micro-vials per minute. Gravity chutes allow the operator to manually feed containers, caps, and plugs to the starwheel for automatic placement, which provides significant cost savings.

The Monoblock Filler/Capper is ergonomically engineered with tubular construction and balcony design for easy inspection and maintenance, and quick size changeover (usually less than 15 minutes). Quick changeover options reduce this time to less than 5 minutes. Containers index directly to the starwheel, which features No Bottle - No Fill - No Cap standard. Fill times may be independent of the starwheel to allow for various fluid fill rates, and the starwheel is mechanically driven with a precision zero-backlash indexer. Interlocked and gasketed polycarbonate machine safety guarding prevents injury to the operator.

Optional vibratory or centrifugal bottle, plug and cap feeders may be integrated with the MB25 to create a fully automated filling and capping line. The system can insert plugs, reducers, dropper tips, and brushes into the container prior to capping. Caps are secured using a mechanical placement and pre-torque mechanism as well as a final torque mechanism. Servo drive, filling, and capping systems may also be ordered as an option. Allen-Bradley PLC and PanelView Plus 600 touchscreen HMI controls are standard with the MB25, and other control options may be specified.

Technical Specifications

Model	MB25	MB25/2
Filling Speed	Up to 60 bpm*	Up to 60 bpm*
Pitch	Single	Dual
Drive Systems (all)	Mechanical (Servo Option)	Mechanical (Servo Option)
Standard Voltages	208V, 240V, 480V, 3-Phase, 60Hz	208V, 240V, 480V, 3-Phase, 60Hz
Capping System	Mechanical (Servo Option)	Mechanical (Servo Option)
System Controls	AB PLC & PanelView Plus 600 HMI	AB PLC & PanelView Plus 600 HMI
Product Types	Creams, Powders, Non-flammable Liquids	Creams, Powders, Non-flammable Liquids
Bottle Size and Fill Range	Round: 1-3.5" H x 0.25-2" Dia. Other Shape: 1-3.5" H x 0.25-2" L x 0.25-2" W 1-50ml	Round: 1-3.5" H x 0.25-2" Dia. Other Shape: 1-3.5" H x 0.25-2" L x 0.25-2" W 1-50ml

*Actual filling speed depends on the application.



Two filling stations, plug inserter station & plug inspection.

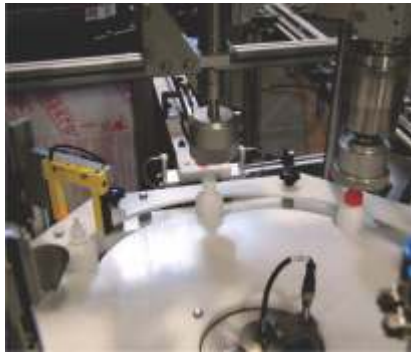

Cap placement and pre-torque (center) & final cap torque (right) stations.



Final Cap Torque Station

Filling Systems Available

- Volumetric Pumps w/ Ball or Rotary Valve
- Rotary Pumps
- Peristaltic Pumps
- Piston Fillers for Cream Products
- Powder Fillers
- Stainless Steel or Ceramic
- Option for Independent Pump Controls

Options

- Servo Upgrade for All Systems
- Automatic Feeders for Caps & Plugs
- Plug/Stopper/Brush Inserter
- Custom Cap or Pump Placement
- Positive Shut Off Nozzles
- Soft Reject System w/ Conveyor
- Quick Changeover Tooling

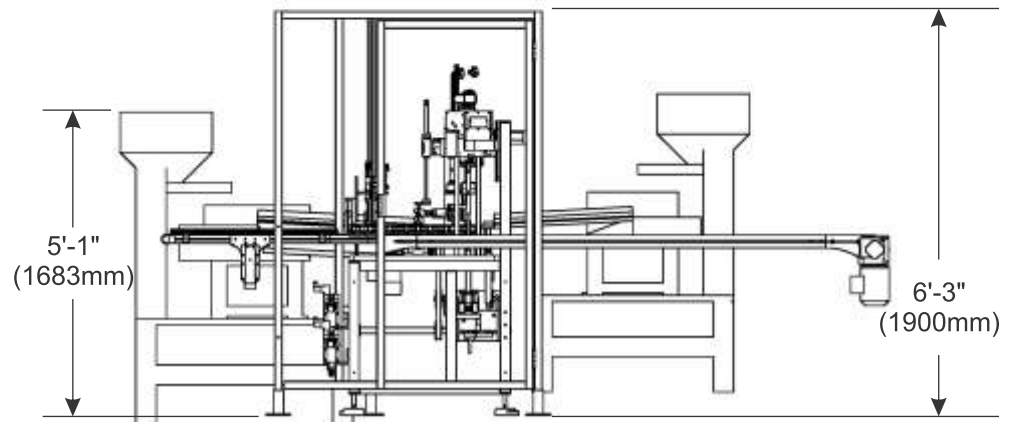
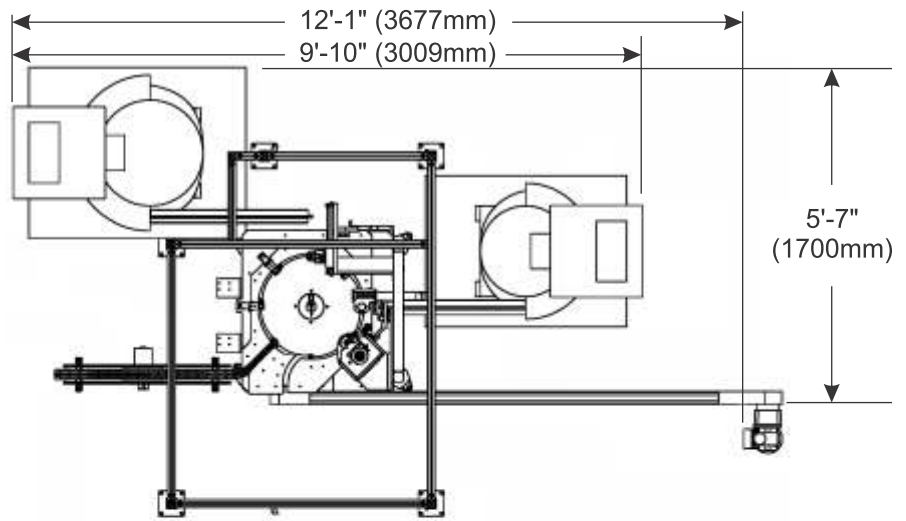

ESS Technologies, Inc.
3160 State Street
Blacksburg, VA 24060
(540) 961-5716 • (540) 961-5721
info@esstechnologies.com
www.esstechnologies.com



ESS
Technologies, Inc.
Packaging Machine Design & Integration

